

# 24' X 24' BREAK ROOM CUBE

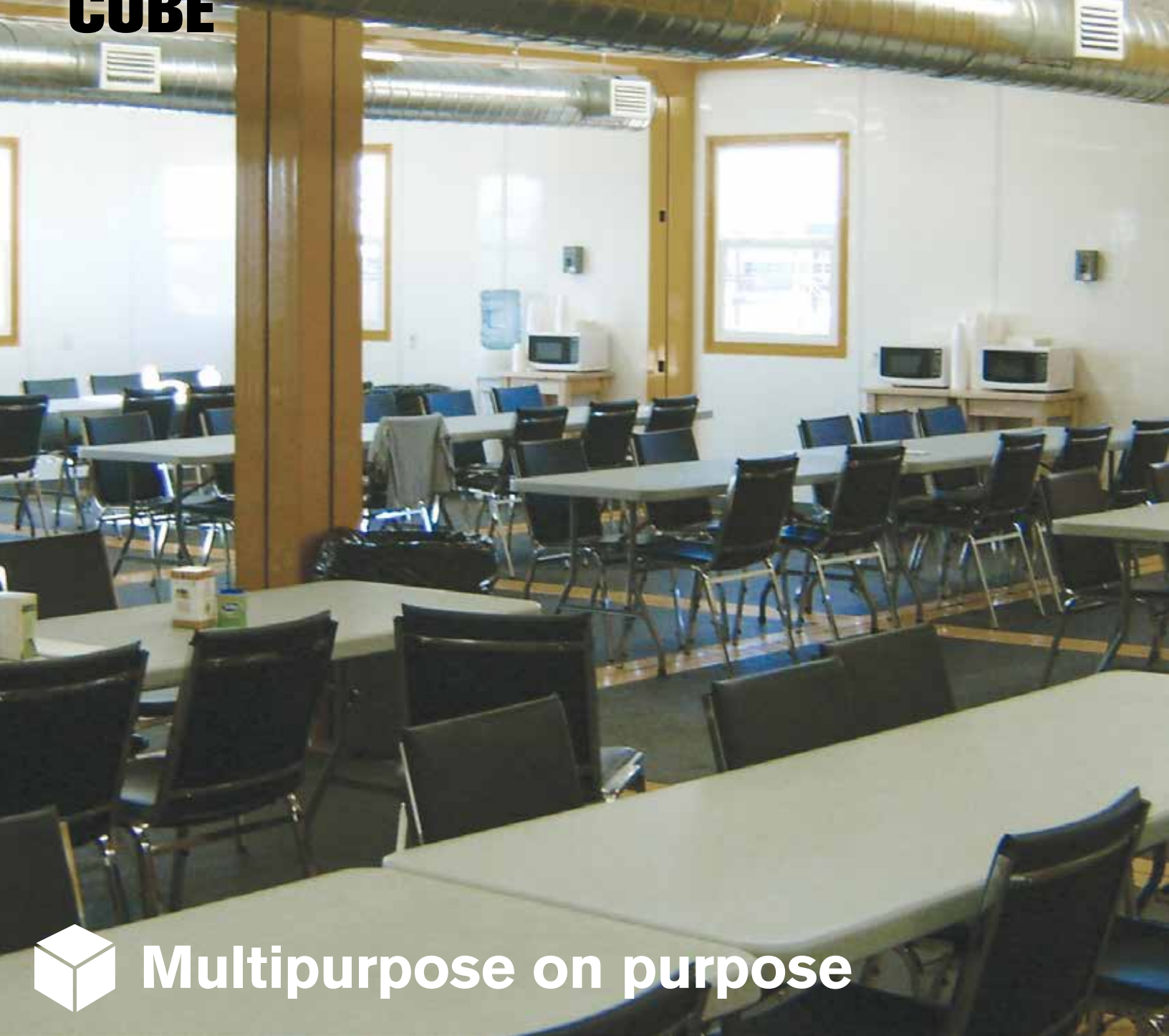

**Multipurpose on purpose**

The 24' x 24' Break Room comes complete with full insulation, electrical, HVAC and large dual-pane windows.

***XTREME CUBES***<sup>™</sup>  
BY XTREME CUBES CORPORATION 

# 24' X 24' BREAK ROOM CUBE

Contact Us  
T: 800-497-1704  
E: [cuberfq@xmg.com](mailto:cuberfq@xmg.com)

## STANDARD FEATURES

- 12'w x 24'l x 10'h space frames with built-in fork pockets (2)
- Imron polyurethane paint - Xtreme white
- 3' x 11' x 9' steel wall panels (7)
- 3' x 11' x 9' steel wall panel with 3' x 7' man door (1)
- 3' x 9' window (1)
- 3' x 11' window (1)
- Exterior single-phase load center and breakers (1)
- Electrical quick-connect plugs
- 8' Interior LED lights (4)
- Emergency ballasts (3)
- Light switches (2)
- Exterior light (1)
- Duplex outlets (12)
- 2.5-ton wall-mount heat pump HVAC with ductwork (1)
- 1-1/8" CDX plywood flooring with 0.05" HDPE laminate
- 3/8" plywood with white HDPE wall paneling
- R-21 spray foam insulation in walls
- R-28 spray foam insulation in floor
- R-35 spray foam insulation in roof

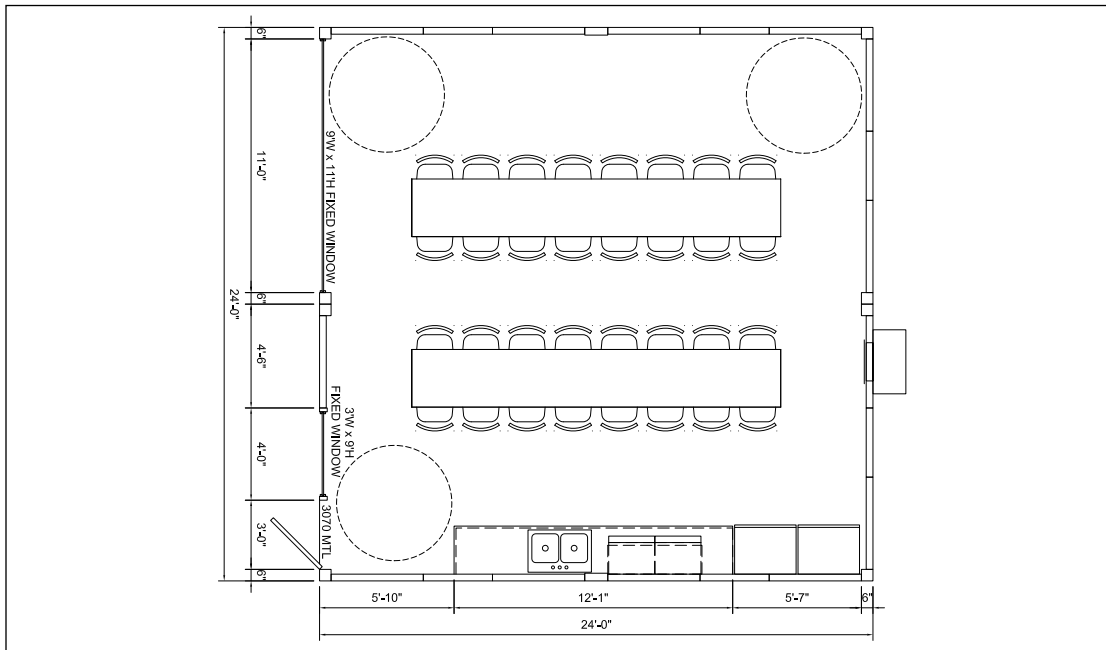

## ABOUT XTREME CUBES

- Welded structural steel tube frame enhances the Cube's overall strength and increases options for customization.
- The standard Cube height is 10'. Cube lengths and widths are available in increments of 8', 10' and 12'.
- Modular wall panels can be easily customized with doors, windows, and other options.
- Premium components are utilized inside and out for durability and long life.
- Each Cube is engineered to your specific location conditions to withstand snow load, wind load and seismic events.
- Utility connections are preconfigured for a convenient and simple installation.
- Installation is quick and simple. When delivered, Cubes can be set in position, connected to site utilities and ready to use immediately.

# XTREME CUBES™

[www.xtremecubescorp.com](http://www.xtremecubescorp.com)